

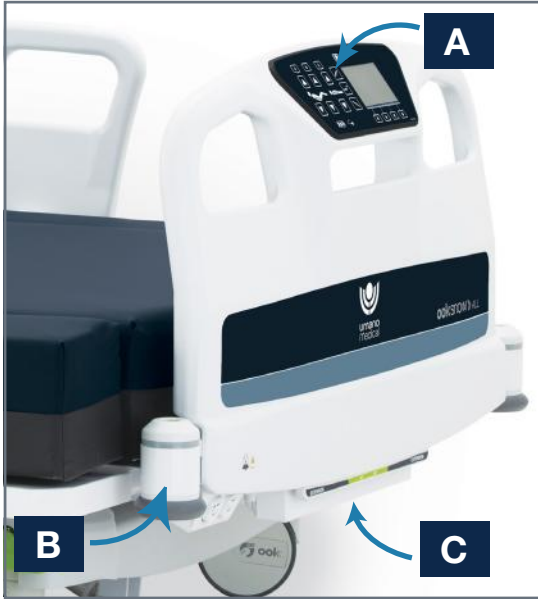

BED OVERVIEW



A Footboard controls

- Motion control lockouts - will illuminate **amber** when locked.
- Bed movements - up and down motions
- One-touch bed positions Trend., Reverse Trend., Vascular Foot
- Battery indicator

B Bed exit side view lights (on foot bumpers)

- Illuminated **green** = Bed exit detection system is armed
- Flashing **amber** = In alarm
- Not illuminated = System not in use

C Bed extender

- Locate **green** handle at foot end of bed.
- Pull to extend & push to retract until a click is heard (indicates bed extender is locked).
- Place the bed extender cushion.



REMINDERS

Ensure bed is plugged in to enable scale, bed exit & advanced features.

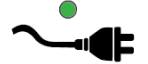

Apply the brakes (push down on **red** arrow)

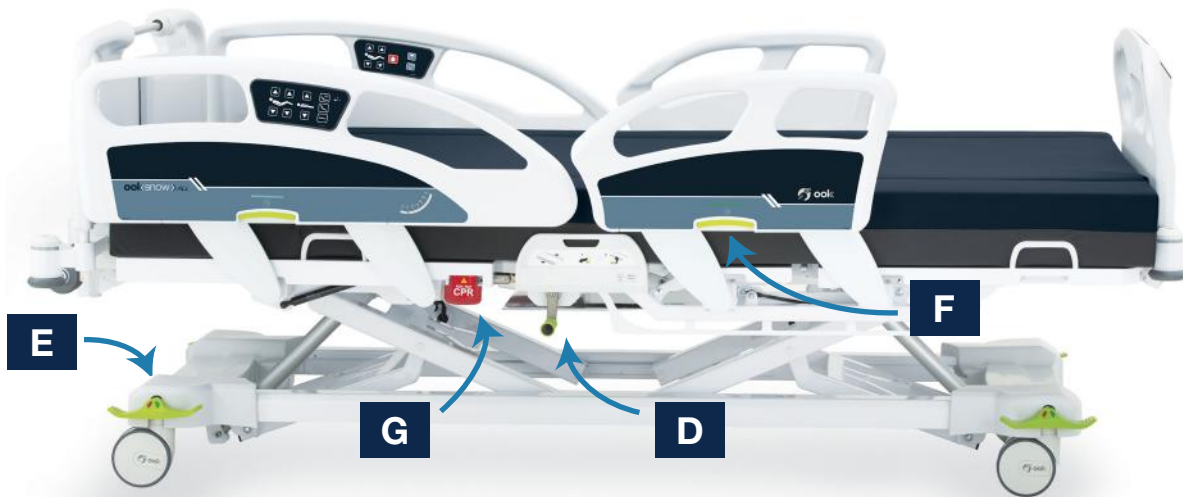

D Infinite™ Width Expansion System

- Pull out crank and turn to expand or to narrow the patient surface (*crank will retract automatically*).

E Brake pedals

- Push **red** = Brake ON
- Push **green** = Steer ON
- Horizontal = Neutral position (Bed is fully mobile)

F Siderail release

- Lift **green** handle UP to unlock.
- Move siderail to desired position.
- **Green** indicator = safe status
- **Red** indicator = unlocked siderail

G CPR release handle

- Pull and hold **CPR** release handle to flatten all sections of patient sleep deck.
- If bed is plugged in, the knee section will retract. Press any control button to cancel.

This medical bed is intended to be used by trained and qualified medical staff. Restrictions apply regarding its use in specific environments. Please refer to the user manual for detailed instructions, safety measures and warnings.

SCALE & BED EXIT

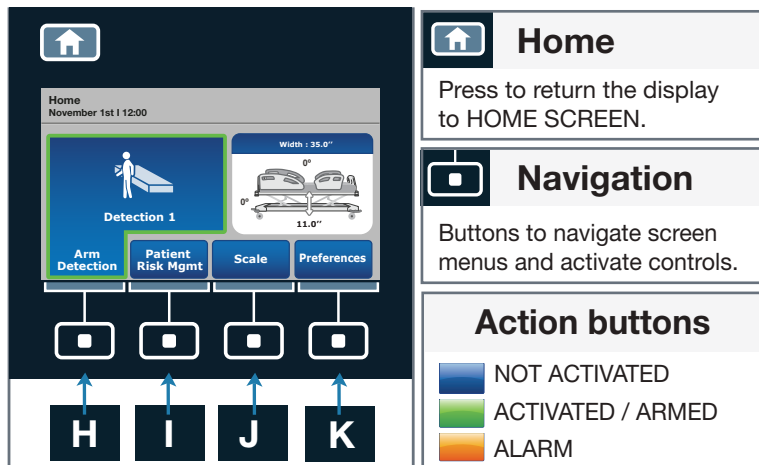

Home

Press to return the display to HOME SCREEN.

Navigation

Buttons to navigate screen menus and activate controls.

Action buttons

- NOT ACTIVATED
- ACTIVATED / ARMED
- ALARM

H Arm/disarm BED EXIT detection system (manual setting)

To **ARM** the bed exit detection system:

Note: The patient must be in bed.

- From HOME SCREEN, select ARM DETECTION.
- Select YES to arm bed exit detection.
- Verify that foot end side view lights are illuminated **green**, which indicates that the bed exit detection system is armed.

To **DISARM** the bed exit detection system (if alarm is triggered):

- From HOME SCREEN, select DISARM.
- This will silence the alarm and allow staff to tend to the patient.

To **DEACTIVATE** the bed exit detection system:

- From HOME SCREEN, select DISARM.
- Select YES to deactivate.

Repeat above steps to rearm the bed exit detection system.

H Arm/disarm AUTO ARM bed exit detection system (automatic setting)

To **ARM** the AUTO ARM bed exit detection system:

- From HOME SCREEN, select ARM DETECTION.
- Select AUTO ARM.
- Select YES to activate.

To **DISARM** the AUTO ARM bed exit detection system (when alarm is triggered):

- From HOME SCREEN, select DISARM to silence the alarm
- If the patient is out of the bed the system will go into stand-by mode.

If the patient is in bed the system will automatically apply a 1-minute care pause to allow staff to reposition the patient.

- Select PAUSE to resume to a 5- or 10-minute care pause, or select STOP PAUSE to cancel.
- Once the patient has been repositioned, the system will return to Auto Arm bed exit detection mode.

To **DEACTIVATE** the AUTO ARM bed exit detection system:

- From HOME SCREEN, select ARM DETECTION.
- Select AUTO ARM.
- Select YES to deactivate.

This medical bed is intended to be used by trained and qualified medical staff. Restrictions apply regarding its use in specific environments. Please refer to the user manual for detailed instructions, safety measures and warnings.

I Set/change BED EXIT detection level

To **SET/CHANGE** bed exit detection level (1-3):

Note: Detection system must be disarmed to make changes.

- From the HOME SCREEN, select PATIENT RISK MANAGEMENT.
- Select SET DETECTION.
- Use ⇌ button to scroll to desired DETECTION.
- Press SELECT DETECTION and select YES to confirm.

J SCALE (weigh, zero, change equipment)

To **WEIGH** the patient:

- From the HOME SCREEN, select SCALE.
- Select WEIGH to view and log patient weight.

To **ZERO** the scale:

Note: Patient must be out of the bed to zero the scale.

- From the HOME SCREEN, select SCALE.
- Use ⇌ button to scroll to ZERO.
- Select START to confirm zero.

If a zero is mistakenly performed:

- Select UNDO ZERO from the zero menu to access and select a previously performed zero.
- Select APPLY ZERO.

To **CHANGE EQUIPMENT** on the bed while the patient is in bed:

- From the SCALE screen, select CHANGE EQUIPMENT.
- Follow the instructions on the screen.

WEIGHT LOG displays previously logged patient weight.

K Clear bed data for NEW PATIENT

To **CLEAR** previous bed data for a NEW PATIENT:

Note: Bed data will be permanently cleared.

- From the HOME SCREEN, select PREFERENCES.
- Use ⇌ button to scroll to NEW PATIENT.
- Press SELECT.
- Data to clear = green / Data to keep = white
- Select CLEAR DATA and select YES to confirm.

To **EDIT** selected data to clear:

- From NEW PATIENT menu, select EDIT.
- Select ⇌ button to scroll through each menu option.
- Data to clear = highlighted ■
- Data to keep = highlighted ■
- Select CLOSE to save changes.
- Repeat above steps to clear data.

K To change ALARM settings (volume and tone)

To change **ALARM SETTINGS**:

Note: Alarm must be off to change settings.

- From the HOME SCREEN, select PREFERENCES.
- Select ⇌ button to scroll to ALARM MANAGEMENT.
- Make desired changes and select OK to save changes.

K Preferences Menu

To manage the follow-up menu items:

- Advanced Settings • Lock • Minimum height Adjustment • Alarm Management • ID/Bed Location • Auto-Contour • New Patient • Maintenance • Lights Configuration