



Siderails



TO LOWER RAIL: Pull up on handle located under siderail. The rail will gradually lower.

TO RAISE RAIL: Pull the siderail upward to its highest position until it locks in place.

Battery Backup

This bed is equipped with an emergency battery backup. The battery will charge when plugged into an AC outlet.

Footboard Controls

To Lock/Unlock specific features:

Press the key button and then press the lock button associated with that feature. Repeating this process will then unlock the feature. While this can only be performed from the footboard control, it affects ALL controls.

1. CPR
2. Nurse Call
3. Cardiac Chair
4. Bed Flat
5. Trend
6. Reverse Trend
7. Head Up/Down Lock
8. Bed Up/Down Lock
9. Foot Up/Down Lock
10. All Functions Lock
11. RSS Controls (see reverse)

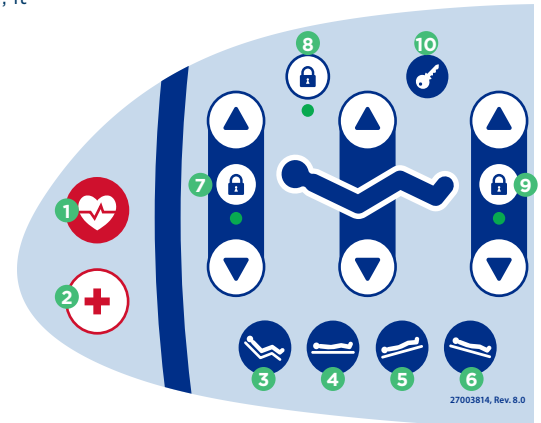
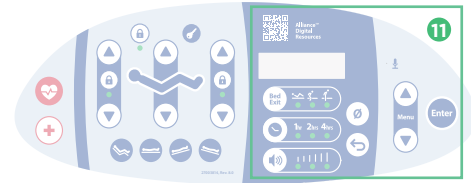

Hand Control



1. Bed Flat
2. Cardiac Chair
3. Head Up/Down
4. Feet Up/Down
5. Bed Up/Down
6. Under-Bed Lighting
7. Nurse Call

Siderail Controls

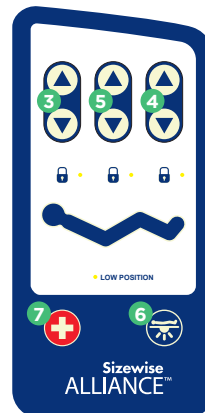

Casters

Green

Stepping on the green pedal locks the right foot caster parallel with frame.

Neutral

Casters are unbraked.

Red

Brakes can be manually applied by stepping down on the red pedal.

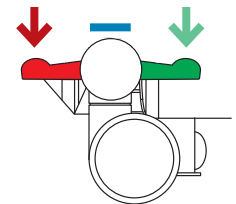

Code Situation

1. Unlock casters and pull bed from wall.
2. Engage brakes, remove headboard, and lower siderails for patient access.
3. For air support surfaces: press CPR button or turn CPR dial on control unit and/or open CPR valve at head of mattress if installed.
4. Squeeze and hold CPR lever located at head of bed. You may also use CPR button located on footboard control to flatten deck.
5. Proceed with facility protocols for resuscitation.

Troubleshooting

Bed will not respond

- Verify all functions on footboard control are unlocked.
- Verify bed's power cord is plugged into working AC outlet and not cut, frayed or damaged.
- Inspect patient hand control for damage and ensure it is properly connected.

Function of bed doesn't operate

- Verify function in question is unlocked on footboard control.

Bed will not operate on battery power

- Verify patient hand control is properly connected.

Warning: Before working on any electrical component, unplug bed and disconnect battery. If these steps aren't performed, damage to the electrical system may occur. If equipment continues to malfunction, call 800-814-9389

REST SECURE SYSTEM™

Keypad Variants

Rev. 7 and earlier



Rev. 8

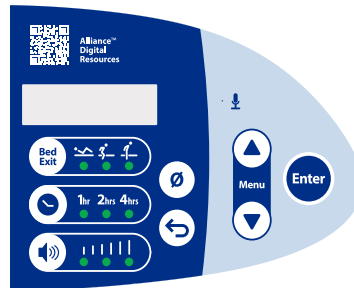

System Setup

1. Plug into wall AC power.
2. Plug in Nurse Call interface (if applicable).
3. Press **ENTER BUTTON** to take system out of standby.

Zero Scale

Press and hold **ZERO BUTTON** for 3 seconds before placing patient in bed.

Weighing Patient

Press the **ENTER BUTTON**.

View patient weight on monitor.

System will enter standby after 60 seconds of inactivity.

To Change Lbs/Kgs

Press **UP** or **DOWN** button.

Select SCALE SETTINGS and press **ENTER**.

Select CHANGE TO LBS or CHANGE TO KGS and press **ENTER**.

Add Remove Items

Press **UP** or **DOWN** button.

Select Add/Remove Items and press **ENTER**.

Press **ENTER** after changes are made.

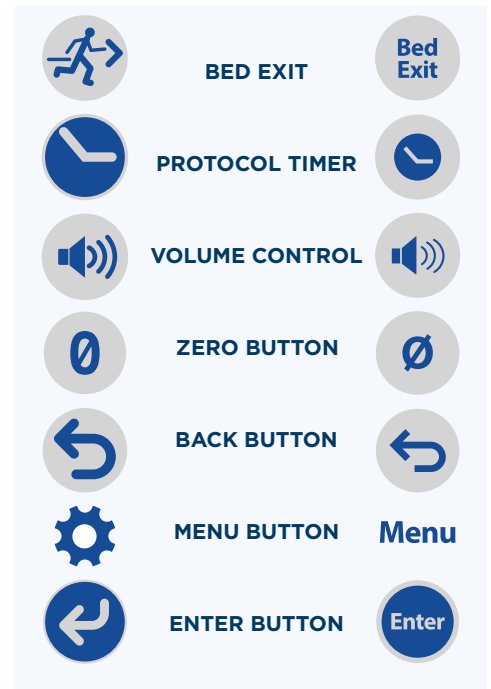

Protocol Timer

Set protocol reminder for 1, 2 or 4 hours.

Press **PROTOCOL TIMER BUTTON** to select desired time.

To disable: Press timer button until indicator lights are off.

BED EXIT ALARM

Activate Alarm

Patient must be in bed prior to activation.

Press the **BED EXIT** button to set desired sensitivity:

HIGH SENSITIVITY:



Do not use with alternation therapy support surface.

MEDIUM SENSITIVITY:



Do not use with rotation therapy support surface.

LOW SENSITIVITY:



Detects when patient has exited the bed.

Reset Alarm

Place patient back in bed. Press the **ENTER** button to reset the alarm and restart monitoring.

Disable Alarm

Press and hold the **BED EXIT** button for 3 seconds to silence and disable alarm.

Bed exit alarm must be reactivated after being disabled.

This guide is not meant to replace the product user manual. For additional product support, call **800-814-9389**.

PRD-0002F-0423 Combines legacy QRGs 27650028 and 27650043. See user manual for full content.

